

Silhouette 100/SELV

- 17mm stylish ultra low profile grille
- Downstream airflow guide vanes for improved pressure development
- Designed for vertical or horizontal application
- Indication light (except B model)
- Fan IPX4 rated - IPX7 rated (SELV)
- Suitable for wall, ceiling, panel and window mounting
- Meets current Building Regulations Approved Document F
- SELV transformer to BS EN 60742
- Improved humidistat function



Slimline Bathroom Ventilation

With a slim profile of only 17mm, Silhouette blends in with the wall surface to provide an unobtrusive installation. Silhouette has a FID performance of 21 l/s. Silhouette can be ceiling/panel mounted and connected to an appropriate duct run to the outside.



Safety Extra Low Voltage (SELV) Fans

Safety Extra Low Voltage (SELV) is designed for areas where a fan has to be fitted within zone 1 in a room containing a fixed bath or shower according to IEE wiring regulations. The Silhouette SELV model can be safely installed within the spray area. SELV models are rated IPX7, control is by a mains safety isolating transformer with 12V DC SELV output, which is sited away from any source of spray and out of reach of a person using a fixed bath or shower.

Models

Silhouette 100B/SELV B

Single speed 100mm bathroom/toilet fan with back draught shutter. Indication light on SELV model only.

Model	Stock Ref
B	454055
SVB (SELV)	439974

Silhouette 100T/SELV T (Timer)

Single speed 100mm bathroom/toilet fan with integral adjustable electronic overrun timer (5-30 minutes), indication light and back draught shutter.

Model	Stock Ref
T	454056
ST (SELV)	439975

Silhouette 100HT (Humidity/Timer)

Single speed 100mm bathroom/toilet fan with integral adjustable auto humidity sensor from 60-90% RH, fixed 15 minute overrun timer option via jump switch, indication light and back draught shutter.

Model	Stock Ref
HT	454057

Silhouette 100 SELV SVH (Humidity)

Single speed 100mm bathroom/toilet fan with integral adjustable auto humidity sensor from 60-90% RH, indication light and back draught shutter.

Model	Stock Ref
SVH (SELV)	439976

Silhouette 100TM (PIR/Timer)

Single speed 100mm bathroom/toilet fan. Integral PIR operated model, (presence detector) with adjustable electronic overrun timer (5-30 minutes) indication light and back draught shutter.

Model	Stock Ref
TM	454058

Accessories

Model	Stock Ref
Wall Kit White	254102
Wall Kit Brown	254100
Window kit	442947

Dimensions (mm)

Panel

Wall Kit

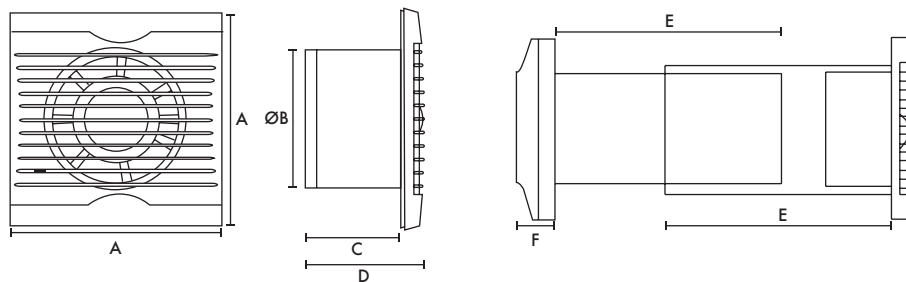

A	BØ	C	D	E	F
160	99	80	97	200	32

Transformer (W X H X D) 147 X 86 X 65

Weight 0.6kg

Fixing hole diameter 105mmØ (Panel & Window), 117mmØ (Wall)

Performance Guide

Model	Extract Performance - FID			Sound dB(A)
	m³/h	l/s	Watts	@ 3m
Silhouette 100B/T/H/TM	75	21	14	30
Silhouette 100SVB/SVT/SVH	75	21	15	30

Silhouette 125

- 18mm stylish ultra low profile grille
- Downstream airflow guide vanes for improved pressure development
- Designed for vertical or horizontal application
- Modern aesthetic with indication light
- Fan IPX4 rated
- Suitable for wall, ceiling and panel mounting



Slimline Bathroom Ventilation

With a slim profile of only 18mm, Silhouette blends in with the wall surface to provide an unobtrusive installation. Silhouette has a FID performance of 160m³/h. Silhouette can be wall, ceiling or panel mounted and connected to an appropriate duct run to the outside.



Models

Silhouette 125B

Single speed 125mm bathroom/toilet fan with indication light and back draught shutter.

Model	Stock Ref
B	445161

Silhouette 125T (Timer)

Single speed 125mm bathroom/toilet fan with integral adjustable electronic overrun timer (5-30 minutes), indication light and back draught shutter.

Model	Stock Ref
T	445162

Silhouette 125H (Humidistat)

Single speed 125mm bathroom/toilet fan with integral adjustable auto humidity sensor from 60-90% RH, indication light and back draught shutter.

Model	Stock Ref
H	445163

Accessories



Model	Stock Ref
Wall Kit	455226

Dimensions (mm)

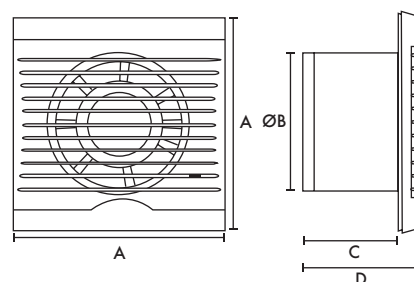

A	B Ø	C	D
187	125	131	149

Performance Guide

Model	Extract Performance - FID			Sound dB(A)
	m ³ /h	l/s	Watts	@ 3m
Silhouette 125B/T/H	160	45	20	40

Silhouette 150

- Stylish ultra low profile grille
- Downstream airflow guide vanes for improved pressure development
- Modern aesthetics
- Electric back draught shutters
- IPX4 rated
- Suitable for wall, ceiling and panel mounting
- Meets current Building Regulations Approved Document F



Slimline Kitchen Ventilation

The Vent-Axia Silhouette range is designed for modern living. With a profile of only 19mm on the kitchen models, Silhouette blends in with the wall surface to provide an unobtrusive installation.

Mounted in the centre of the fan, beneath the ultra slim profile grille, are the electronics, incorporating a humidistat for detecting a change in internal humidity or an overrun timer option that is adjustable between 5 and 30 minutes.

Accessories

Model	Stock Ref
Wall Kit White	140902
Wall Kit Brown	140903

Models

Slim profile only 19mm. FID performance of 241 m³/h, double insulated.

Silhouette 150X

Single speed 150mm kitchen fan with electric back draught shutter.

Model	Stock Ref
X	454059

Silhouette 150XT

Single speed 150mm kitchen fan with integral adjustable electronic overrun timer (5-30 minutes), indication light and electric back draught shutter.

Model	Stock Ref
XT	454060

Silhouette 150XH

Single speed 150mm with integral adjustable auto humidity sensor from 60-90% RH, indication light and electric back draught shutter. Switch live for override by remote switch/light switch.

Model	Stock Ref
XH	454061

Dimensions (mm)

Panel

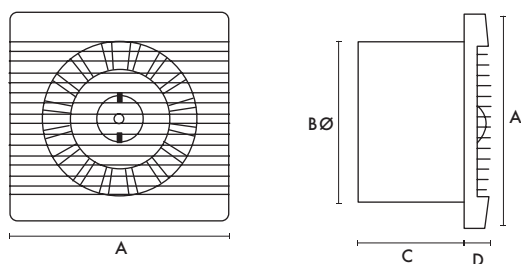

Wall

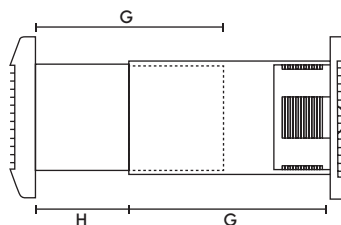

Fixing hole diameter 1.52mmø (when wall kit used)

A	B	C	D	G	H
223	147	111	19	220	37

Weight 1.75kg

Performance

Model	Extract Performance - FID			Sound dB(A)
	m ³ /h	l/s	Watts	@ 3m
Silhouette 150X/XT/XH	241	67	20	43